

PFR780

- | | |
|---------------------------|-----------------------------------|
| 1 DRAG KNOB SCREW | 19 CLUTCH BB ASSY |
| 2 DRAG KNOB | 20 RETAINED SPRING |
| 3 DRAG CLICKER | 23 CASSETTE |
| 4 DRAG CLICKER SPRINGS | 24 DRAG CLICKER |
| 5 RETAINED SPRING | 24a CLICKER SPRING |
| 6 DRAG COVER | 24b CLICKER ASSEMBLED STAND |
| 7 SPRING WASHER | 24c CLICKER ASSEMBLED STAND SCREW |
| 8 SQUARED WASHER*2 | 25 HANDLE SCREW*2 |
| 9 TEFLON WASHER*4 | 26 SPOOL |
| 10 METAL DRAG WASHER *2 | 27 SPOOL RELEASE SPRING |
| 11 MAIN SHAFT CLIP*2 | 28 SPOOL RELEASE LEVER |
| 12 MAIN SHAFT BEARING*2 | 29 COUNTERWEIGHT |
| 13 FOOT SCREW*2 | 30 SPOOL RELEASE CAP |
| 14 FOOT | 31 RELEASE CAP SCREW |
| 15 MAIN BODY | 32 BUSH |
| 16 "O" RING | 33 HANDLE SPINDLE |
| 17 MAIN SHAFT | 34 HANDLE |
| 18 RETAINED BEARING | |

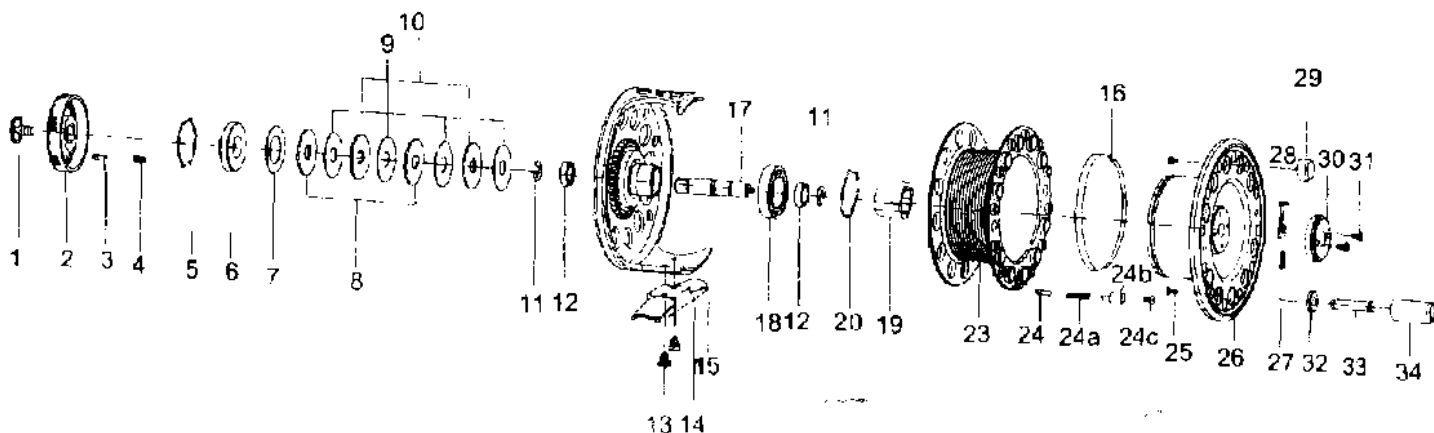

Instructions for converting to Right Hand Wind

"Remove the Retained spring (part 20) out of its groove and remove the part 19 turn over and reassemble all parts in the same order with part 19 facing in the opposite direction."